

# Model—SA-440V/E

## 101.6mm DEEP SAND TRAP LOUVER



Ontario Specialty Architectural Products FZE certifies that the Sand Trap Louver Model “SA 440V/E” is licensed to bear the AMCA seal. The ratings shown are based on tests and procedures performed in accordance with AMCA Publication 511 and comply with the requirements of the AMCA Certified Ratings Program. The AMCA Certified Ratings seal applies to air performance and wind driven sand performance ratings only.



### AIRFLOW PERFORMANCE:

- Free Area: 28.6%; based on a test sample of 48in (1219.2mm) x 48in (1219.2mm)
- Airflow Classification—Class 3
- Static Pressure Loss: **Not more than (16 Pa) @ (1.2 m/s) Face Velocity**

### WIND DRIVEN SAND REJECTION PERFORMANCE:

Free Area Velocity (m/s)	1	2.5	4	5.5	7
Weight of Sand (kg)	1	1	2	2	2
Discharge Duration (s)	200	75	100	70	60
Sand feed rate (kg/s)	0.005	0.013	0.020	0.029	0.033
Effectiveness (%)	82	50	18	7	3
Penetration Class	B	D	D	D	D

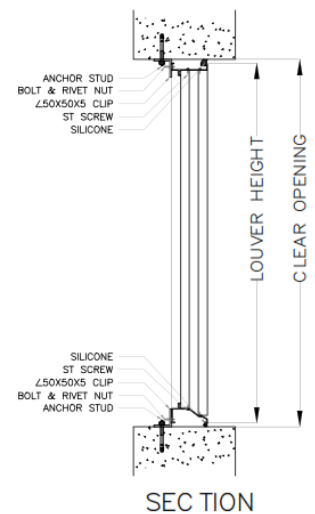
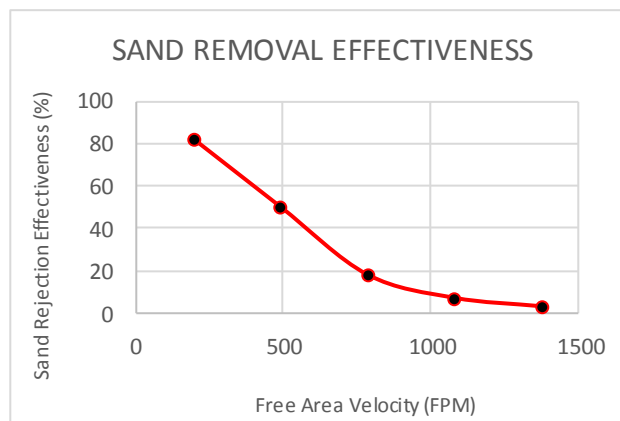

**Test Data:** Grading of the sand used for wind driven sand performance tests shall be as per Annex H, Table 8, of ANSI/AMCA Standard 500-L.

### System Description:

101.6mm deep extruded aluminum construction; frame with channel profile; corner joints mitered and mechanically fastened, with continuous recessed caulking channel each side; tested for wind driven sand & air performance in accordance with ANSI/AMCA standard 500-L.

### Material & Finishes:

- SA-440V/E comprises 2-rows of 100mm wide vertical sand trap blades in 101.6mm deep extruded aluminum frames. A galvanized steel option is also available.
  - Blades: Vertical—Sand trap
  - Frame depth: 101.6mm deep
- Metal Thickness: Frame 2mm; blades (1.6mm—2mm) options are available.
- Finish: PE-SDF / PVDF / Anodize after fabrication
- Color: As scheduled.
- Mullions: Exposed
- Screens: Bird mesh / Insect mesh
- Screen location: Interior
- Screening Material: Aluminum / Stainless Steel

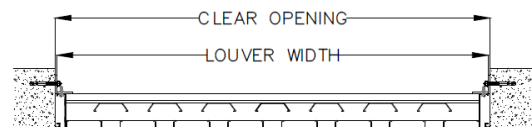

### Louver Construction:

- Wind Load Resistance: Design to resist +ve and –ve wind load of \_\_\_ psf (\_\_\_ kPa) without damage or permanent deformation.
- Blades: One piece extrusions with reinforcing bosses, supported and lined up with heavy-gage extruded aluminum blade braces, positively interlocked to each blade and mechanically secured to structure by aluminum and stainless steel fastenings.
- Exposed edges and ends of metal dressed smooth, free from sharp edges.
- Exposed connections and joints constructed to exclude water.

### Warranty:

OSA louvers warranted for 2 years against defective material and workmanship, and 20 Years for Finishes.

# Model—SA-440V/E

## 101.6mm DEEP SAND TRAP LOUVER



		FREE AREA (ft <sup>2</sup> and m <sup>2</sup> )									
		WIDTH (IN & mm)									
		12	24	36	48	60	72	84	96	108	120
		305	610	914	1219	1524	1829	2134	2438	2743	3048
HEIGHT (IN & mm)	12	0.29	0.62	0.95	1.29	1.62	1.95	2.29	2.62	2.95	3.29
	305	0.03	0.06	0.09	0.12	0.15	0.18	0.21	0.24	0.27	0.31
	24	0.43	0.93	1.43	1.93	2.43	2.93	3.43	3.93	4.43	4.93
	610	0.04	0.09	0.13	0.18	0.23	0.27	0.32	0.37	0.41	0.46
	36	0.71	1.55	2.38	3.21	4.05	4.88	5.71	6.55	7.38	8.21
	914	0.07	0.14	0.22	0.30	0.38	0.45	0.53	0.61	0.69	0.76
	48	1.00	2.17	3.33	4.59	5.67	6.83	8.00	9.17	10.33	11.50
	1219	0.09	0.20	0.31	0.43	0.53	0.64	0.74	0.85	0.96	1.07
	60	1.28	2.78	4.28	5.78	7.28	8.78	10.28	11.78	13.28	14.78
	1524	0.12	0.26	0.40	0.54	0.68	0.82	0.96	1.10	1.23	1.37
	72	1.57	3.40	5.24	7.07	8.90	10.74	12.57	14.40	16.24	18.07
	1829	0.15	0.32	0.49	0.66	0.83	1.00	1.17	1.34	1.51	1.68
	84	1.85	4.02	6.19	8.35	10.52	12.69	14.86	17.02	19.19	21.36
	2134	0.17	0.37	0.58	0.78	0.98	1.18	1.38	1.58	1.78	1.99
	96	2.14	4.64	7.14	9.64	12.14	14.64	17.14	19.64	22.14	24.64
	2438	0.20	0.43	0.66	0.90	1.13	1.36	1.59	1.83	2.06	2.29
	108	2.42	5.26	8.09	10.93	13.76	16.59	19.43	22.26	25.09	27.93
2743	0.23	0.49	0.75	1.02	1.28	1.54	1.81	2.07	2.33	2.60	
120	2.71	5.88	9.04	12.21	15.38	18.54	21.71	24.88	28.05	31.21	
3048	0.25	0.55	0.84	1.13	1.43	1.72	2.02	2.31	2.61	2.90	

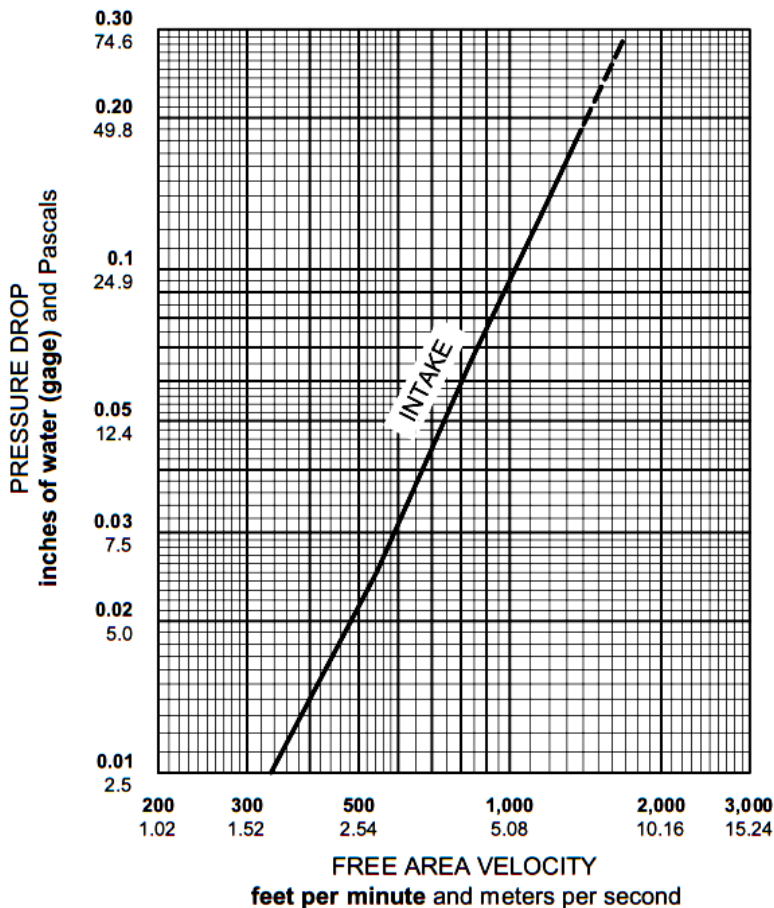

### Test Data

- Published data is in accordance with ANSI/AMCA 500-L, Figure 5.5.
- Data is corrected to standard air density.
- Test sample size: 48in (1220mm) x 48in (1220mm)