

MODEL : XWGS & XWCGS

Description:

Flush mounted exterior wall, expansion joint system ,with aluminum frames and secondary barrier.

Technical Data:

- Metals :Extruded Aluminum - 6063-T6
ASTM B221
- Santoprene Seals: Single Durometer Gasket
ASTM D2000,UV resistant

Material Finishes:

- Aluminum frame are in clear anodized as standard finish.
- Gasket are available in black, gray, beige and white* colors

Limitations:

- Standard length 3 meter
- Maximum length 6.1 meter

Optional Accessories:

- Silicon sealant

Installation:

See manufacturer's standard installation Instructions.

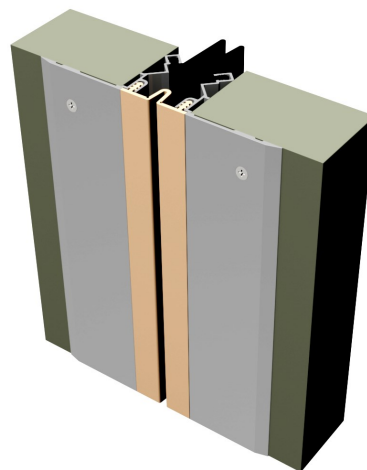

Santoprene™
Santoprene Seals

Key Features:

- Surface mounted application for ease of installation
- Movement up to +/-50%
- With weatherproof back seal
- Multi directional movement capability

Applications:

- Where flush mount application is not possible
- Available for gap sizes of 2" up-to 6"

Model	Min Joint Opening	Nominal Joint Width (W)	Max Joint Opening	Exposed Surface (ES)	Overall Width	Overall Height
XWGS2	1.25" (32mm)	2.00"(51mm)	3.00" (76mm)	6.95"(177mm)	6.95"(177mm)	N/A
XWGS3	1.25" (32mm)	3.00"(76mm)	4.50" (114mm)	7.95"(202mm)	7.95"(202mm)	N/A
XWGS4	1.25" (32mm)	4.00"(102mm)	6.00" (152mm)	8.95"(227mm)	8.95"(227mm)	N/A
XWCGS2	1.25" (32mm)	2.00"(51mm)	3.00" (76mm)	4.48"(114mm)	4.48"(114mm)	N/A
XWCGS3	1.25" (32mm)	3.00"(76mm)	4.50" (114mm)	5.48"(139mm)	5.48"(139mm)	N/A
XWCGS4	1.25" (32mm)	4.00"(102mm)	6.00" (152mm)	6.48"(164mm)	6.48"(164mm)	N/A

Wall to Wall

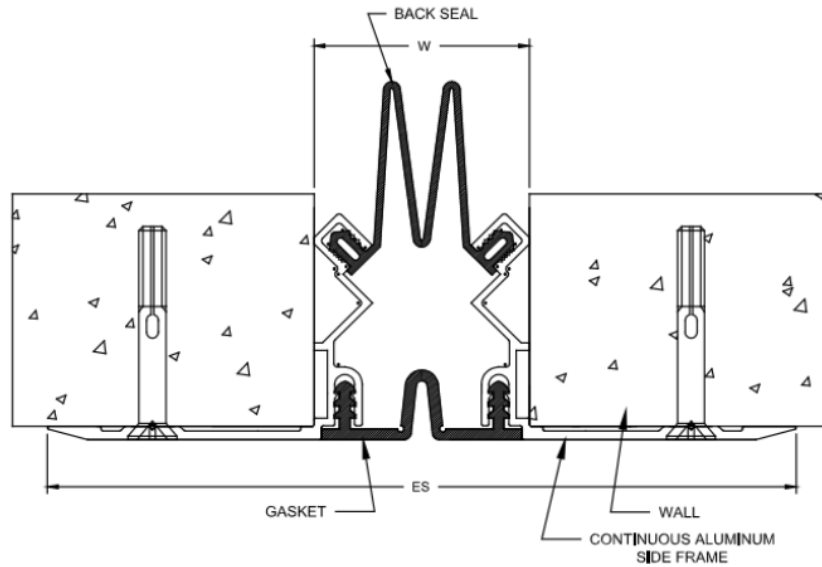

XWGS

Wall Corner

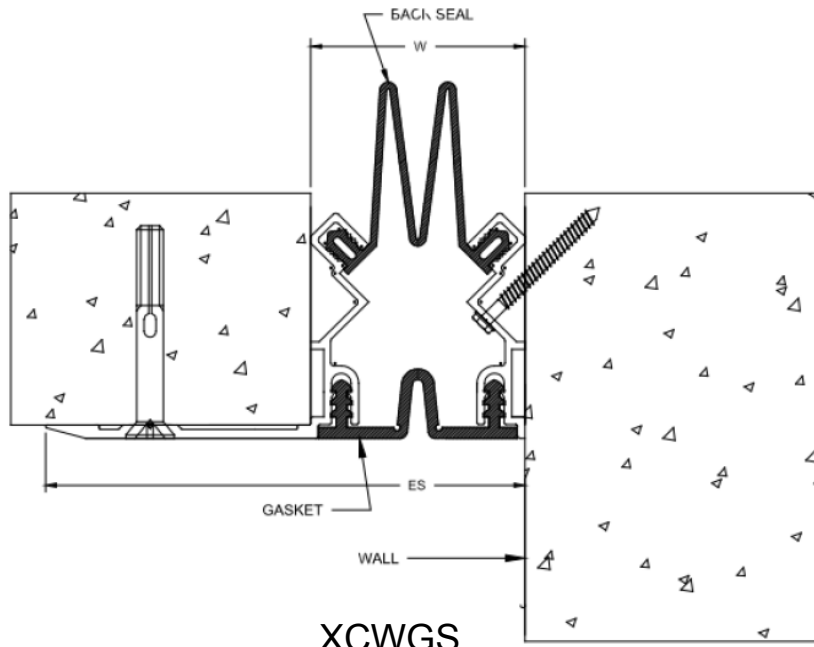

XCWGS